

THE KANGAROO PRO JUNIOR

HOW TO INSTALL YOUR MONITOR — attaching your monitor to the Ergo Desktop mount, 5/32 allen wrench and M4 screws provided

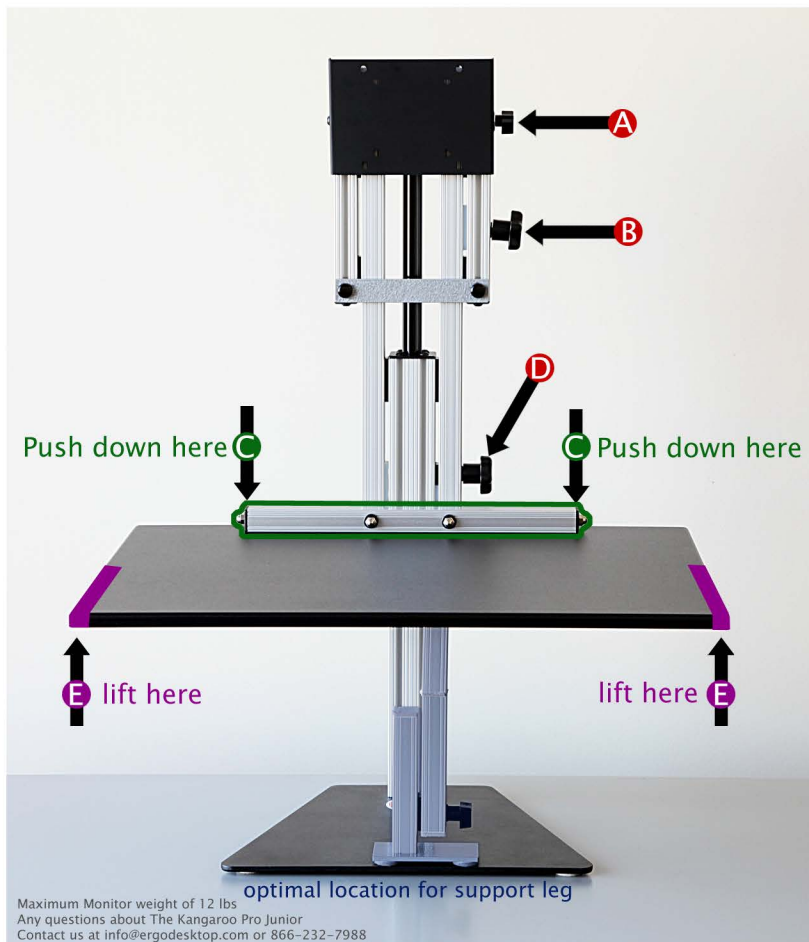
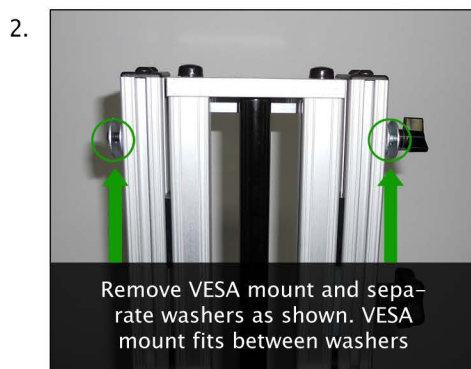
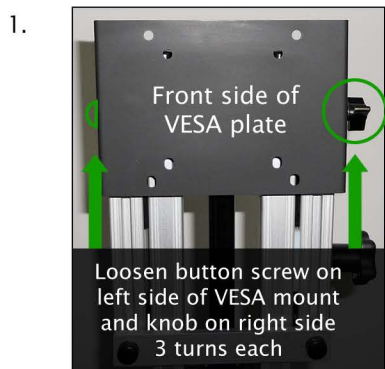

HOW TO USE THE PRO JUNIOR

To raise the Pro Junior, loosen the main brake(D) and lift the main work surface on the sides(E & E). After reaching the desired height, tighten the work surface brake. Loosen the monitor brake(B) and raise the monitor. After reaching the desired height tighten the monitor brake. Place the stabilization leg included with your unit, between the work surface and steel base plate.

To lower the Junior, remove the stabilization leg, loosen the main brake(D) and lean into the unit using your upper body weight pushing down with both hands on the horizontal bar at the rear of the main horizontal work surface (C & C). After the Work Surface is lowered, tighten the work surface brake(D) and loosen the monitor brake(B). Lower the monitor to the desired height then tighten the monitor brake.

A. Mount Brake – controls tilt

B. Monitor Brake

C. Work Surface Rail

D. Main Brake

E. Main Work Surface



THE STABILIZATION LEG

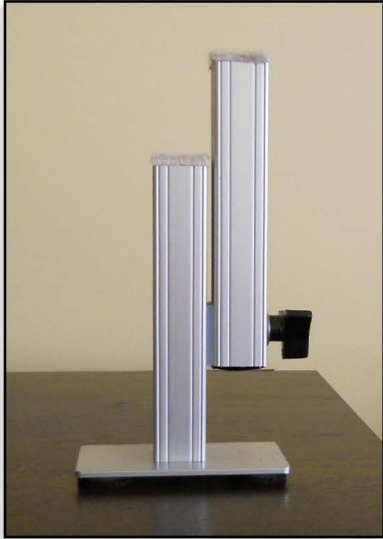

Your adjustable height desk unit comes with an adjustable leg that can be used to give you maximum stability when you are using “The Kangaroo” in the standing position.

Raise The Kangaroo work surface to your desired standing height and tighten the work surface brake.

Place the adjustable leg under the work surface and loosen the adjustable leg brake. Only loosen the brake by a turn or two, to much and the brake will disengage from the slot.

Extend the adjustable leg until it engages the bottom of the work surface and then tighten the adjustable leg brake.

The leg is shipped with the **extension section** installed to give you additional height adjustment. If this is too tall for your application, simply **unscrew the extension section**.

- A** Extension Selection
- B** screws into here

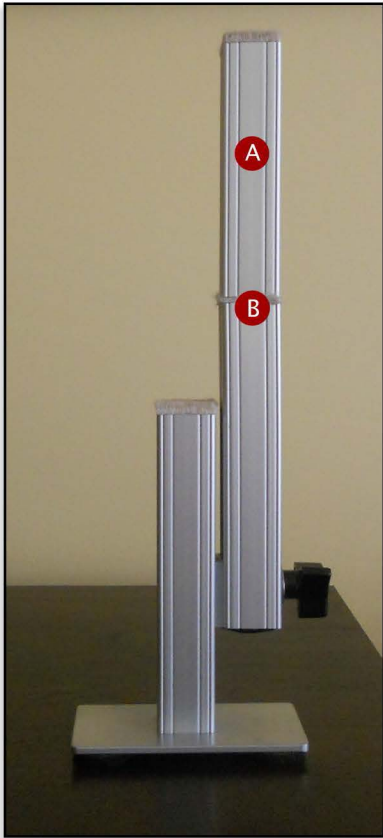

ALWAYS REMOVE LEG BRACE BEFORE LOWERING THE WORK SURFACE.



Stabilization leg shown without the Extension Selection

