

## Positioning Your Laptop Stand

### Hug It

While using your LEVO with a chair, you can position the base to hug the corner. That's why our base is shaped like an hourglass.

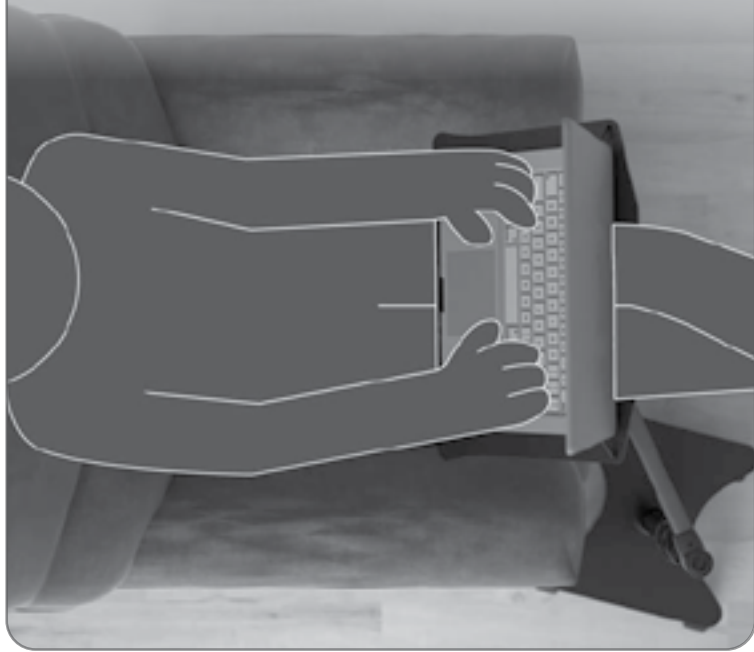

### Straight Ahead

Another way to position your LEVO is directly in front of your chair. The base makes a nice foot rest. Plus, you can control the position of your laptop with your feet... really. Give it a try.



### Sit to Stand

If you like sit to stand, your new LEVO can help. You can use the quick lever height locks to go from sit to stand, and back again.



### SITTING



### RECLINED



### IN BED

Let us know how you use your LEVO. Send us an email to [sales@LEVOstore.com](mailto:sales@LEVOstore.com)

## Optional LEVO Add-ons

[Levo.store.com](http://Levo.store.com)

### BOOK PLATFORM

If your LEVO is for tablets, you can add this Book Platform to read books.



### DUAL CLAMP TABLET CRADLE

If your LEVO is for books, you can add this Dual Clamp to hold your tablets.



Levo

# OWNER'S MANUAL

## G2 Deluxe Laptop Workstation #33761



# Questions?

Please Do Not Contact Your Retailer

As the manufacturer, we are most knowledgeable of this item. If you have any questions or issues regarding your new LEVO, use one of the methods below to contact our customer service.



1-800-928-2322

1-863-815-7077 (Outside the USA)



[sales@LEVOstore.com](mailto:sales@LEVOstore.com)



[www.LEVOstore.com](http://www.LEVOstore.com)



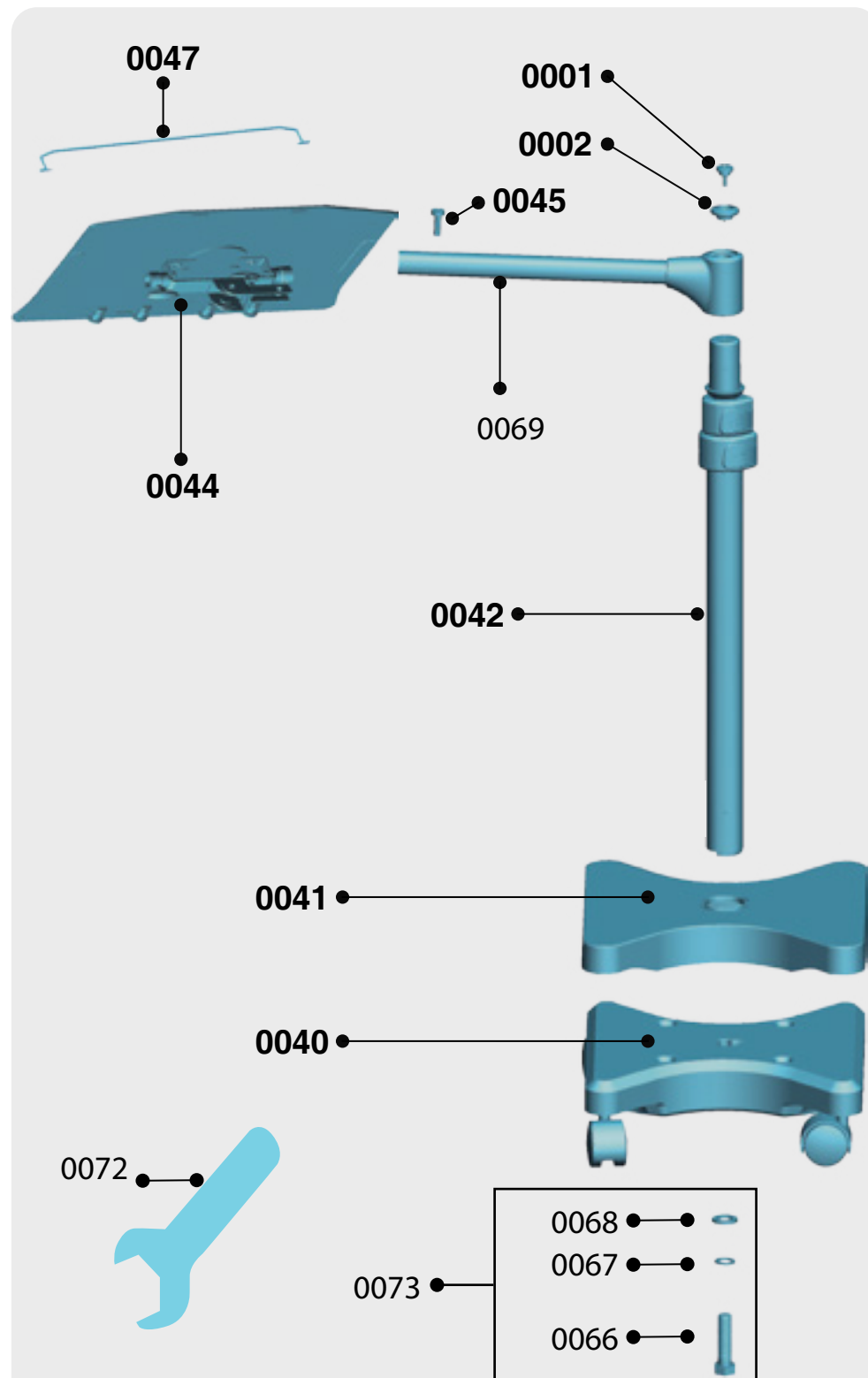

PART#	DESCRIPTION	PART#	DESCRIPTION
0001	Tension Dial	0066	M16 Hex Bolt
0002	Tension Ram	0067	M16 Lock Washer
0040	Hourglass Base	0068	M16 Washer
0041	Cover for Hourglass Base	0069	Horizontal Arm
0042	Triple Column	0071	Caster - 11mm Stem
0044	Laptop Platform	0072	M16 Hex Wrench
0045	Laptop Bracket Screw		

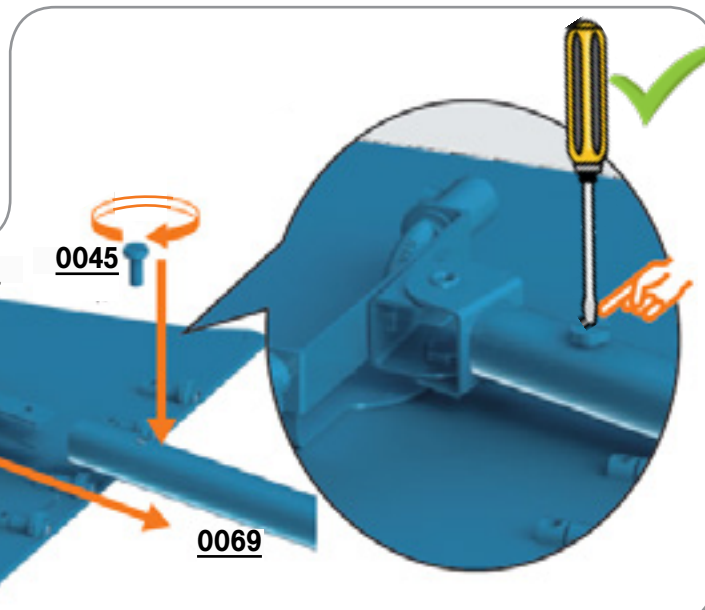
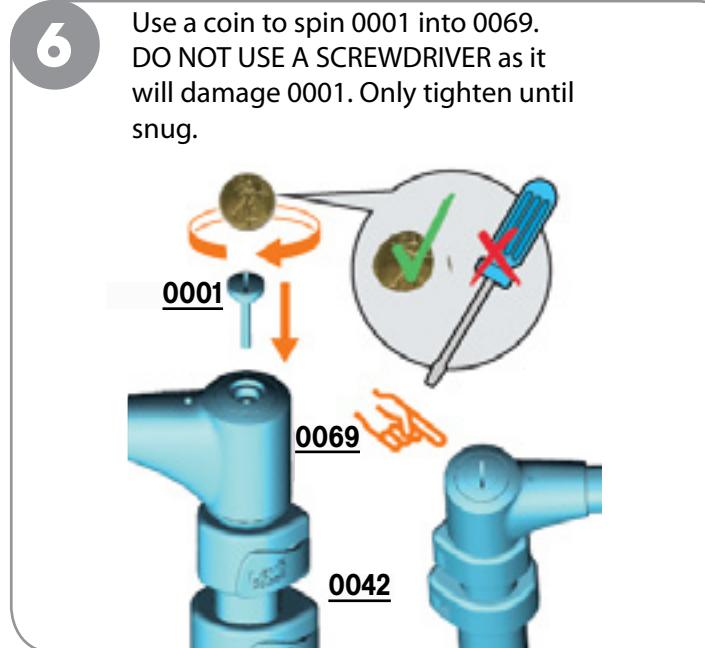
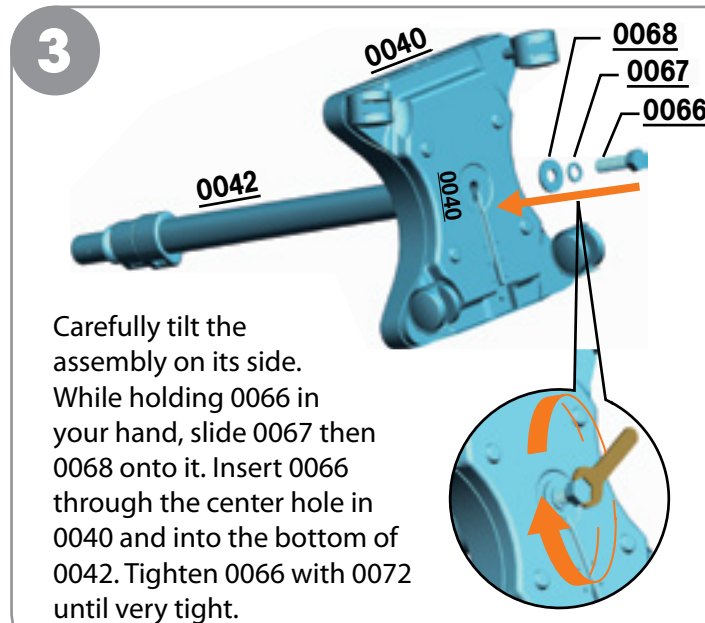
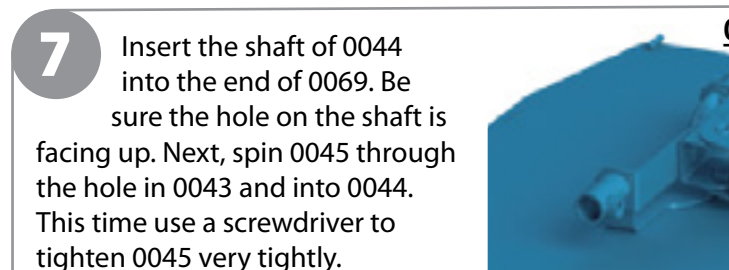
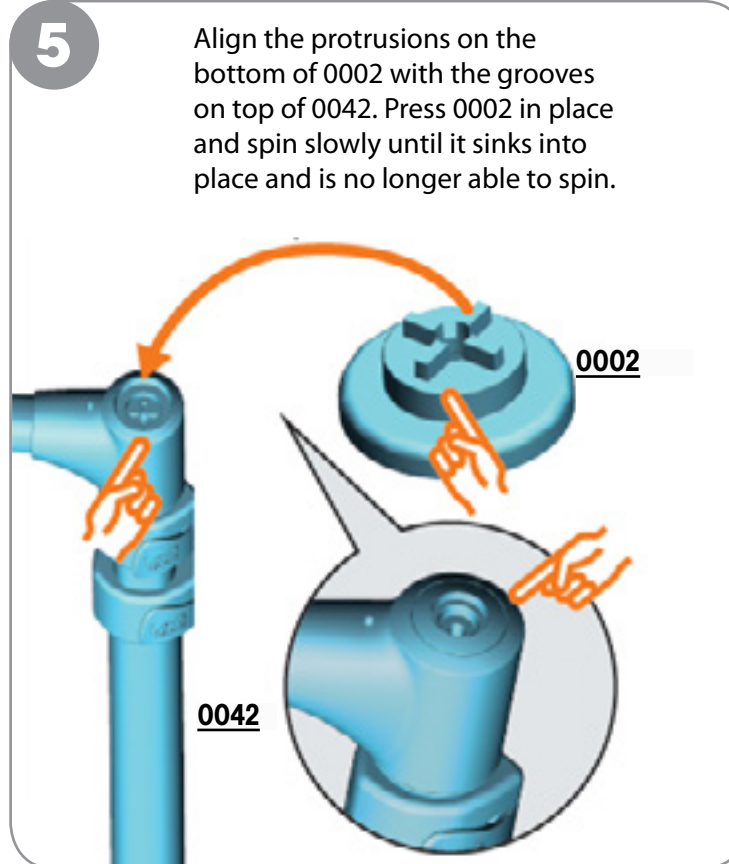
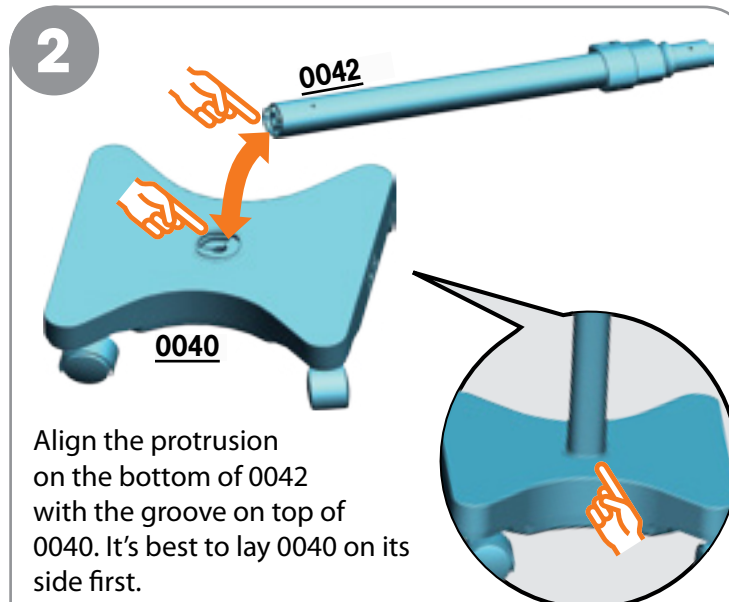
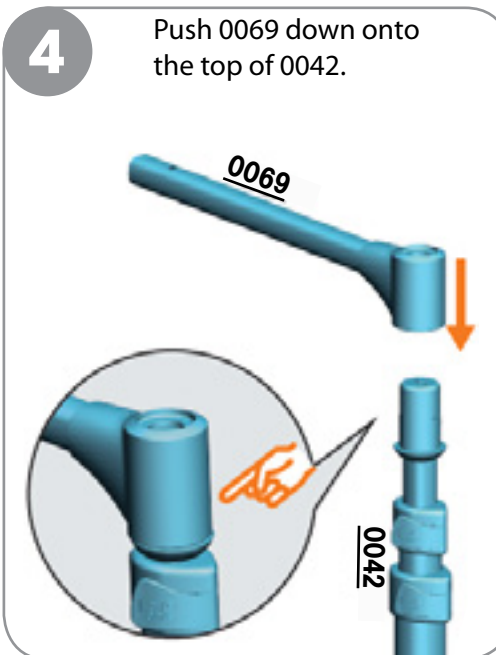
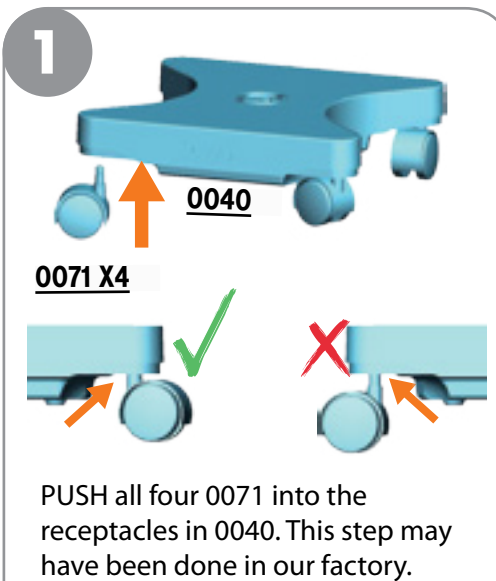

## Using Your Workstation

### Using the Safety Cord

It's important to use the Safety Cord as extra security for your laptop.

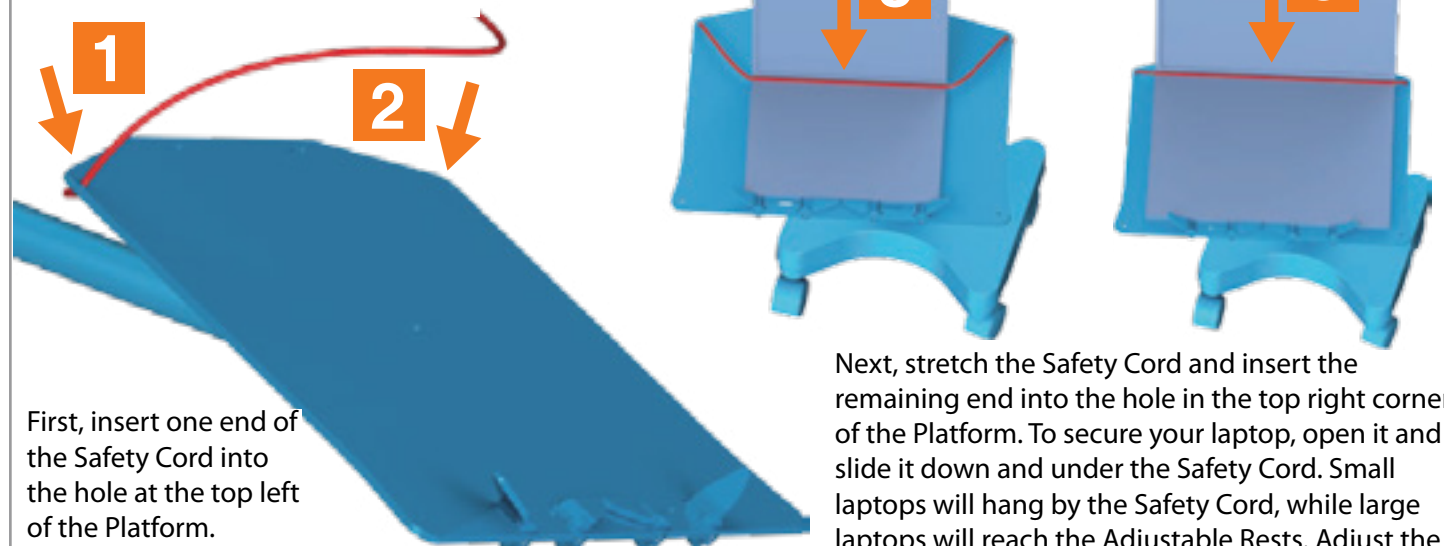

### Fine Tuning

Your height locks have adjustable tension that is set in our factory. If they loosen a bit over time, you can easily adjust them. When properly adjusted, the upper section should not drop into the lower section when the locks are closed. To adjust them, first remove your tablet. Second, open the Height Lock. Third, rotate the screw only 1/8 of a turn clockwise to tighten or counterclockwise to loosen. If needed, repeat the process.

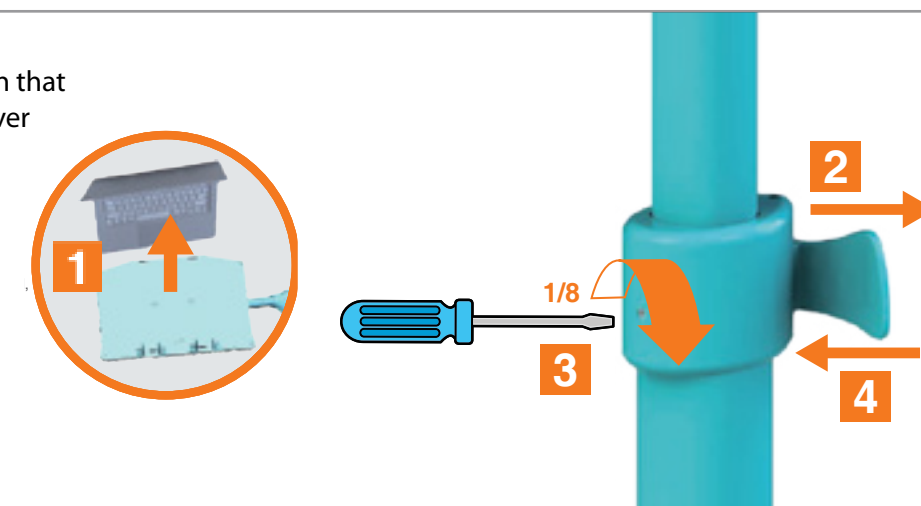

### Micro Adjustment Knob

To keep your Platform level left to right, we added a Micro Adjustment. Tighten or loosen the knob to adjust the force required to move the Micro Adjustment. Some users like it tight while others like it a bit loose.

